

6 

SISTEMA CASSEFORME BIOGAS

BIOGAS FORMWORK SYSTEM
SISTEMA DE ENCOFRADOS BIOGÀS
SYSTÈME DE COFFRAGES BIOGAZ

IT - US - EN - ES - FR





6 

SISTEMA CASSEFORME BIOGAS

BIOGAS FORMWORK SYSTEM
SISTEMA DE ENCOFRADOS BIOGÀS
SYSTÈME DE COFFRAGES BIOGAZ

SISTEMA CASSEFORME BIOGAS

BIOGAS FORMWORK SYSTEM
SISTEMA DE ENCOFRADO BIOGÀS
SYSTÈME DE COFFRAGES BIOGAZ

ACCESSORI

ACCESSORIES
ACCESORIOS
ACCESSORIES





SISTEMA DI CASSERATURA PER LA REALIZZAZIONE DI VASCHE CIRCOLARI SENZA BARRE PASSANTI

FORMWORK SYSTEM FOR MAKING CIRCULAR TANKS WITHOUT THROUGH BARS

SISTEMA DE ENCOFRADO PARA LA CONSTRUCCIÓN DE TANQUES CIRCULARES SIN BARRAS PASANTES

SYSTÈME DE COFFRAGE POUR LA RÉALISATION DE CUVES CIRCULAIRES SANS BARRES PASSANTES

Il Sistema BioGas è costituito da pannelli completamente metallici di dimensione contenuta. Il sistema permette la costruzione di vasche circolari con raggio minimo di 7 metri (22' 11"), assicurando la perfetta tenuta delle strutture, senza dover ricorrere ad alcun tirante. I lati orizzontali dei pannelli sono piani e presentano dei fori per accogliere o gli accessori di serraggio verticale o i montanti parapetto. I pannelli interni, fissati al pannello adiacente per mezzo di cunei, sono anche collegati a dei piantoni verticali con dei puntoni fissi o regolabili, creando così una struttura di sostegno atta a sopportare la pressione del calcestruzzo in fase di getto. Viene a crearsi inoltre un adeguato piano di lavoro per ospitare le maestranze in fase di getto.

The BioGas System permits the construction of circular tanks with a minimum radius of 7 metres (22' 11") and ensures the perfect tightness of the structures without having to use tie-rods. It consists of completely metallic panels with reduced dimensions and with the wet surface, calendered with a very large curvature radius, is concave or convex depending on whether the panels are for shoring up the inner face or the outer face of the circular pour. The horizontal sides of the panels are flat and have holes for the vertical tightening accessories or the parapet uprights. As well as fixing to the adjacent panel by means of wedges, the inside panels are connected by fixed or adjustable props to vertical struts, creating a support structure suitable for supporting the pressure of the concrete during the pouring stage. Furthermore, it creates an adequate and safe working platform for the workers during the concrete casting.

El Sistema Biogás está constituido por paneles totalmente metálicos de dimensiones reducidas. El sistema permite construir cubas circulares con un radio mínimo de 7 metros (22' 11"), garantizando la resistencia de las estructuras, sin necesidad de recurrir a tirantes. Los lados horizontales de los paneles son planos y presentan orificios en los que se introducen los accesorios de ajuste vertical o los montantes del parapeto. Los paneles internos, fijados al panel adyacente mediante cuñas, también están unidos a columnas verticales con puntales fijos o regulables, creando así una estructura de soporte apta para resistir la presión del hormigón durante el vertido. Además, se crea un plano de trabajo adecuado para el personal durante el vertido.

Le système BioGaz est constitué de panneaux entièrement en métal de dimension réduite. Le système permet la construction de cuves circulaires d'un rayon minimal de 7 mètres (22' 11") en garantissant une parfaite étanchéité des structures sans devoir recourir aux tirants. Les côtés horizontaux des panneaux sont plats et présentent des trous pour accueillir soit les accessoires de serrage vertical soit les montants des garde-corps. Les panneaux internes, fixés au panneau adjacent au moyen de clavettes, sont également raccordés à des étaçons verticaux avec des étais fixes ou réglables, en créant ainsi une structure de support apte à supporter la pression du béton lors de la coulée. Ainsi se forme également un plan de travail adéquat pour accueillir les travailleurs en phase de coulée.



CASSAFORMA ESTERNA

EXTERNAL FORMWORK
ENCOFRADO EXTERNO
COFFRAGE EXTERNE

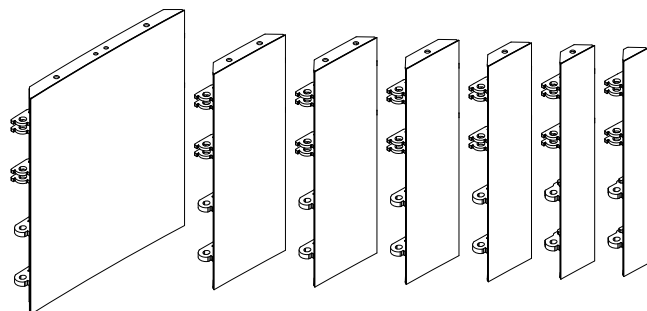
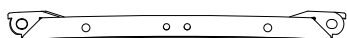

Mis. mm ft in	Cod. N°	Peso kg lbs
Mis Medida Dimensions	Code n° Codigo n° Code n°	Weight Peso Poids
1000x825 3' 3"x2' 8"	8169272	46,39 102.27
1000x375 3' 3"x1' 2"	8169276	27,75 61.18
1000x325 3' 3"x1'	8169273	25,64 56.53
1000x275 3' 3"x10"	8169277	23,42 51.63
1000x225 3' 3"x8"	8169274	20,97 46.23
1000x175 3' 3"x6"	8169278	20,43 45.04
1000x125 3' 3"x4"	8169275	20,51 45.22

CASSAFORMA INTERNA

INTERNAL FORMWORK
ENCOFRADO INTERNO
COFFRAGE INTERNE

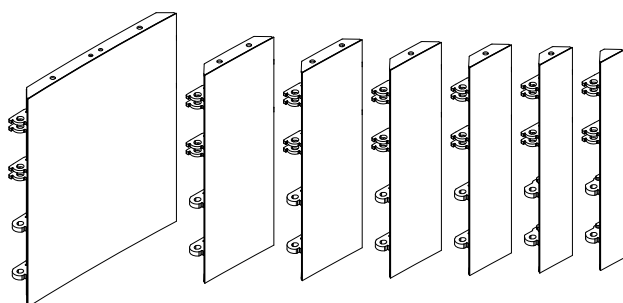

Mis. mm ft in	Cod. N°	Peso kg lbs
Mis Medida Dimensions	Code n° Codigo n° Code n°	Weight Peso Poids
1000x800 3' 3"x2' 7"	8169279	44,65 98.44
1000x350 3' 3"x1' 1"	8169283	25,56 56.35
1000x300 3' 3"x11"	8169280	23,35 51.48
1000x250 3' 3"x9"	8169284	20,95 46.19
1000x200 3' 3"x7"	8169281	20,67 45.57
1000x150 3' 3"x5"	8169285	17,13 37.77
1000x110 3' 3"x4"	8169282	14,81 32.65



PANNELLI SPECIALI E PER IL DISARMO
 SPECIAL PANELS AND FOR THE DISMANTLING
 PANELES ESPECIALES Y PARA EL DESENCOFRADO
 PANNEAUX SPÉCIAUX ET POUR LE DÉCOFFRAGE

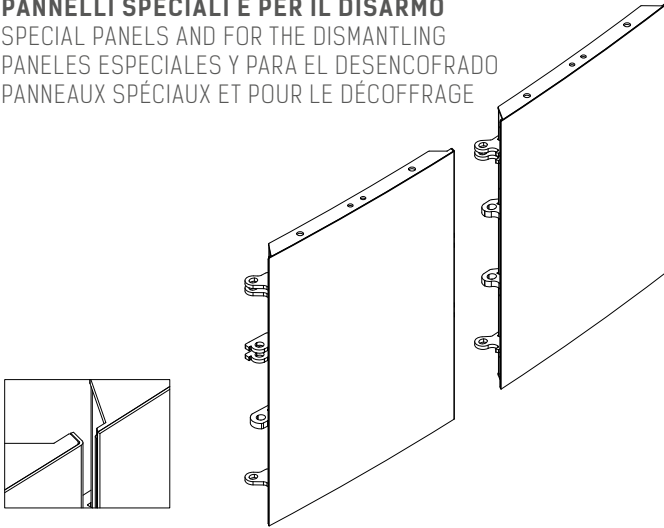

Mis. mm ft in	Cod. N°	Peso kg lbs
Mis Medida Dimensions	Code n° Codigo n° Code n°	Weight Peso Poids
1000x805 3' 3"x2' 7"	8169286D	45,50 100.31
1000x797 3' 3"x2' 7"	8169286S	44,00 97.00





PUNTONE FISSO

FIXED STRUT
 PUNTAL FIJO
 ÉTANÇON FIXE

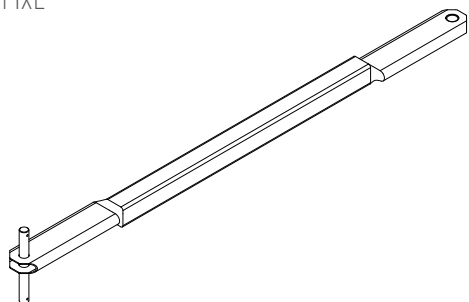

PUNTONE REGOLABILE

ADJUSTABLE STRUT
 PUNTAL REGOLABILE
 ÉTANÇON RÉGLABLE

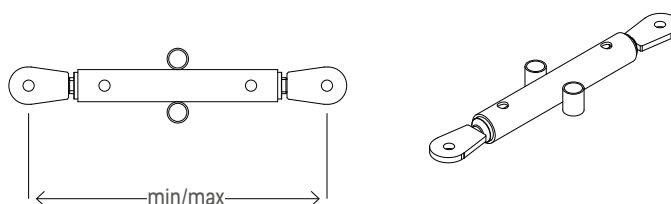

Mis. mm ft in	Cod. N°	Peso kg lbs
Mis	Code n°	Weight
Medida	Codigo n°	Peso
Dimensions	Code n°	Poids
1245 4' 1"	8169288	4,20 9.26
1165 3' 9"	8169289	3,40 7.50

Mis. mm ft in	Cod. N°	Peso kg lbs
Mis	Code n°	Weight
Medida	Codigo n°	Peso
Dimensions	Code n°	Poids
560-790 1' 10"-2' 7"	8169290	6,30 13.89
380-560 1' 2"-1' 10"	8169292	4,80 10.58
315-430 1'-1' 4"	8169291	4,00 8.82
260-320 10"-1'	8169299	3,40 7.50

CHIAVISTELLO PER SPINE

BOLT FOR PINS
 LLAVE PARA CLAVIJAS
 VERROU POUR AXES A CLAVETTE

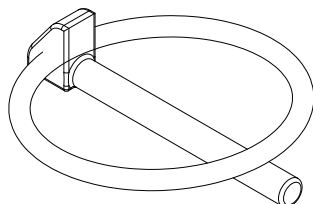

SPINA AUSILIARIA

AUXILIARY PIN
 CLAVIJA AUXILIAR
 AXE AUXILIAIRE

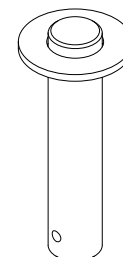

Cod. N°	Peso kg	Peso lbs
Code n°	Weight kg	Weight lbs
Codigo n°	Peso kg	Peso lbs
Code n°	Poids kg	Poids lbs
8168616	0,10	0,22

Cod. N°	Peso kg	Peso lbs
Code n°	Weight kg	Weight lbs
Codigo n°	Peso kg	Peso lbs
Code n°	Poids kg	Poids lbs
8169295	0,30	0,66



STAFFA TIRANTE SUPERIORE

UPPER TIE BRACKET
 SOPORTE SUPERIOR DE LAZO
 SUPPORT DE FIXATION SUPERIEUR

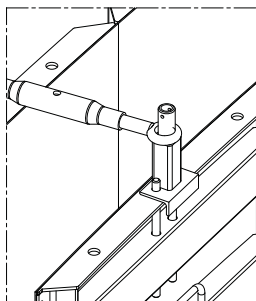
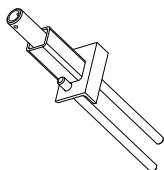

Cod. N°	Peso kg	Peso lbs
Cod. n°	Weight kg	Weight lbs
Codigo n°	Peso kg	Peso lbs
Code n°	Poids kg	Poids lbs
9169223	1,80	3,97

STAFFA FISSAGGIO TRAVE VERTICALE

VERTICAL BEAM FIXING BRACKET
 SOPORTE DE FIJACIÓN DE VIGA VERTICAL
 SUPPORT DE FIXATION DE POUTRE VERTICALE

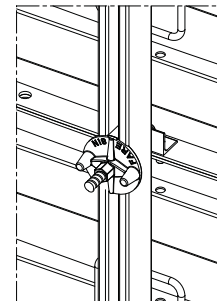
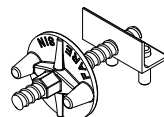

Cod. N°	Peso kg	Peso lbs
Cod. n°	Weight kg	Weight lbs
Codigo n°	Peso kg	Peso lbs
Code n°	Poids kg	Poids lbs
9169224/C	1,80	3,97

DOPPIA TRAVE ALLINEATRICE

DOUBLE ALIGNING BEAM
 VIGA DE ALINEACIÓN DOBLE
 DOUBLE POUTRE ALIGNANTE

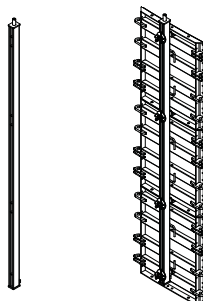

Cod. N°	Peso kg	Peso lbs
Cod. n°	Weight kg	Weight lbs
Codigo n°	Peso kg	Peso lbs
Code n°	Poids kg	Poids lbs
9169225	20,00	44,09

STAFFA ATTACCO PIOMBATORE

PLUMBER FIXING BRACKET
 SOPORTE FIJACION DEL TORNAPUNTA
 GRIFFE DE FIXATION STABILISATEUR

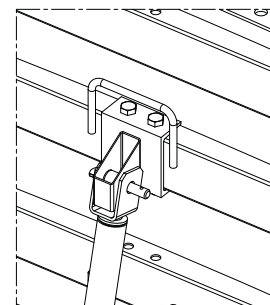
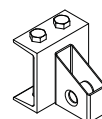

Cod. N°	Peso kg	Peso lbs
Cod. n°	Weight kg	Weight lbs
Codigo n°	Peso kg	Peso lbs
Code n°	Poids kg	Poids lbs
9169226/C	2,20	4,85

PUNTONE PER ALTEZZA 2 E 4 METRI

PLUMBER FOR HEIGHT 2 AND 4 METERS
 PUNTAL PARA ALTURA DE 2 Y 4 METROS
 TIGE POUSSANTE POUR HAUTEUR 2 ET 4 METRES



Cod. N°	Peso kg	Peso lbs
Cod. n°	Weight kg	Weight lbs
Codigo n°	Peso kg	Peso lbs
Code n°	Poids kg	Poids lbs
9169227	35,00	77,16



MONTANTE VERTICALE

UPRIGHT
MONTANTE VERTICAL
MONTANT VERTICAL

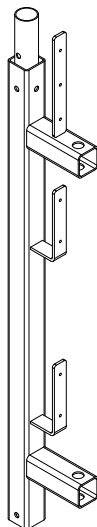

PARAPETTO VASCHE BIOGAS

BIOGAS TANKS RAILING
PARAPETO TANQUES BIOGÁS
GARDE-CORPS CUVES BIOGAZ

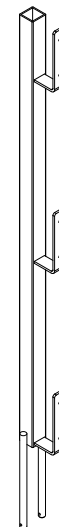

Mis. mm ft in	Cod. N°	Peso kg lbs
Mis	Code n°	Weight
Medida	Codigo n°	Peso
Dimensions	Code n°	Poids
2000 6' 6"	8169293	13,00 28.66
1000 3' 3"	8169294	7,00 15.43

Cod. N°	Peso kg	Peso lbs
Cod. n°	Weight kg	Weight lbs
Codigo n°	Peso kg	Peso lbs
Code n°	Poids kg	Poids lbs
8169296	5,00	11.02

CUNEO DI SERRAGGIO BIO

LOCKING WEDGE
CUÑA DE BLOQUEO BIOGÁS
CLAVETTE DE SERRAGE BIO

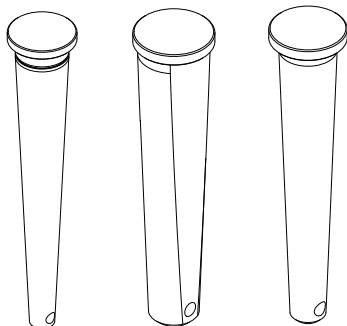

MORSETTO BIO

BIO-CLAMP
MORDAZA BIOGÁS
ÉTAU BIO

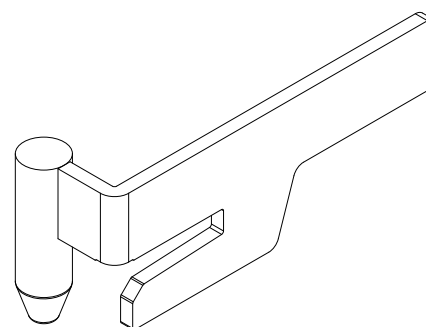

Cod. N°	Peso kg	Peso lbs
Cod. n°	Weight kg	Weight lbs
Codigo n°	Peso kg	Peso lbs
Code n°	Poids kg	Poids lbs
8169287	0,40	0.88
8169298I	0,30	0.66
8169298E	0,40	0.88

Cod. N°	Peso kg	Peso lbs
Cod. n°	Weight kg	Weight lbs
Codigo n°	Peso kg	Peso lbs
Code n°	Poids kg	Poids lbs
8169297	0,50	1.10







Worldwide

CORPORATE HEADQUARTERS

ITALY / BREGANZE

FARESIN FORMWORK S.P.A.

Via della Meccanica, 1 - 36042 Breganze, Vicenza
Phone +39 0445 300300
info@faresinformwork.com - www.faresinformwork.com

ITALY / SALERNO

FARESIN RENTAL S.R.L.

Via Verticelli, 27 - 84022 Campagna, Salerno
Phone +39 0828 1818300
info@faresinrental.com - www.faresinformwork.com

WORLDWIDE BRANCHES

CANADA

FARESIN FORMWORK SYSTEMS INC

99 Fenmar Dr Toronto ON M9L 1M3
Phone +1 416 779 2286
info@faresinformwork.com
www.faresinformwork.ca

ROMANIA

FARESIN ROMÂNIA SRL

Str. Morii, Nr. 6 Mogoșoaia
077135 Judetul Ilfov
Phone +40 21 3514401
office@faresinromania.ro
www.faresinformwork.ro

AUSTRALIA

FARESIN AUSTRALIA PTY LTD.

13 Rowood Road, Prospect
NSW 2148
Phone +61 2 9636 1411
info@faresinaustralia.com.au
www.faresinformwork.com.au

MÉXICO

FARESIN FORMWORK LATAM

OFFICE:

Dr. Vertiz 1400-1401
Colonia Portales Norte
033033 Ciudad de Mexico
Phone +55 25806350

U.S.A.

FARESIN FORMWORK USA CORP

350 5th Avenue
New York, NY 10118
info@faresinformwork.com
www.faresinformwork.us

RUSSIA

JSCO FARESIN SPB

Basseyaya Str. 73/1
196211 St. Petersburg
Phone +7 812 379 71 74
petersburg@faresin.ru
www.faresin.ru

QUEENSLAND OPERATIONAL BRANCH

1/70 Flame Trees Drive
Luscombe QLD 4207
Phone +61 2 9636 1411
info@faresinaustralia.com.au
www.faresinformwork.com.au

WAREHOUSE:

C. Montes Urales 727 piso 5 Lomas
Virreyes, Lomas de Chapultepec
IV Secc, Miguel Hidalgo, C.P. 11000
Ciudad de México, CDMX
info@faresinformwork.com
www.faresinformwork.com

NIGERIA

FARESIN FORMWORK NIGERIA LIMITED

6th Floor, CBC Towers, 11, Olubunmi
Owa Street Off Admiralty Way, Lekki
Phase - Lekki, Lagos State
Phone +234 806 721 4806
info@faresinformwork.com
www.faresinformwork.ng

BELARUS

FARESIN BEL

Surganova Street, 28A, Office 207
220012 Minsk
Phone +375 172909520
faresin@infonet.by
www.faresinformwork.com

MOZAMBIQUE

FARESIN FORMWORK MOÇAMBIQUE LIMITADA

Av. Rua Paulo Samuel Kankhomba,
Bairro Central n. 1371
Kampfumu, Maputo Cidade
Phone +258 21329684
infomz@faresinformwork.com
s.santi@faresinformwork.com
m.cossa@faresinformwork.com
www.faresinformwork.co.mz

ABUJA OFFICE

Suite A3, Triple H Plaza,
Plot 778 Wuye Discript,
Abuja, F.C.T
info@faresinformwork.com
www.faresinformwork.ng